

USER MANUAL

SMART SWHS

EN

Download APP, use QR code

Picture 1

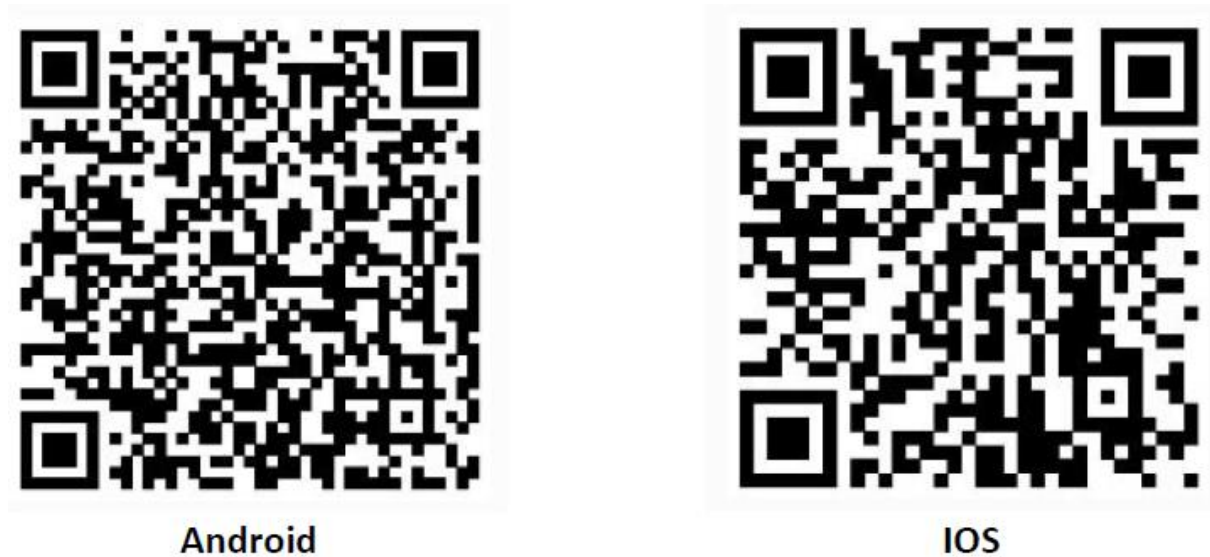

FUNCTION MODULE	FUNCTION	SUB-FUNCTION	DESCRIPTION
Remote monitoring	Sign in	Password Login	Log in to the system through the account password
		Retrieve the password	Retrieve password through email verification
			Retrieve password through mobile phone verification
		Sign up	Verify the registered account by email
			Verify the registered account through mobile phone
	Multilingual	Support switching between Chinese and English for the current APP	
	Device Information	Add Device	Support for adding devices using Bluetooth, scanning for adding devices, adding devices manually
		Device List	Add Device
		Device monitoring	Support to view the currently selected number of pickers PN, temperature, PV voltage, PV

			power, power generation on the day, commercial power status, working mode, fault alarm
Device Settings	Device Name		Modify the name of the currently viewed device
	Water heater settings		Support to issue instructions to the current settings: photovoltaic maximum water heating temperature, Utility maximum water heating temperature, manual heating, synchronization time, timing heating, turn off utility auto-heating, timer 1, timer 2
	Data logger settings		Restart the currently viewed device
			Delete the currently viewed data logger
Me	Phone number		The current account supports binding mobile phone numbers and changing mobile phone numbers.
	Email		The current account supports binding and changing mailboxes.
	Change Password		Support to modify the login password of the current login account, support to use new password to login at the next login
	Account Cancellation		Support to cancel the account and all information data under the account after devices are deleted.
	Wi-Fi monitoring		Wi-Fi local monitoring
	Bluetooth monitoring		Bluetooth local monitoring
	Distribution network tools		Supports router network configuration for connected devices
	Log out		Sign out of the login APP

Wi-Fi monitoring	Wi-Fi connection	Support to view the current connection Wi-Fi, connection status
	Device Information	Support to view the currently selected data logger PN, temperature, PV voltage, PV power, Daily power energy, Utility status, Operating mode, fault warning
	Device Settings	Support to issue instructions to the current settings: photovoltaic maximum water heating temperature, Utility maximum water heating temperature, manual heating, synchronization time, timing heating, turn off utility auto-heating, timer 1, timer 2
Bluetooth monitoring	Device Nearby	Monitor device data in seconds by connecting devices via Bluetooth
	Device Information	Support to view the currently selected data logger PN, temperature, PV voltage, PV power, Daily power energy, Utility status, Operating mode, fault warning
	Device Settings	Support to issue instructions to the current settings: photovoltaic maximum water heating temperature, Utility maximum water heating temperature, manual heating, synchronization time, timing heating, turn off utility auto-heating, timer 1, timer 2

REMOTE MONITORING

Password Login

Enter the mobile phone number or email address you used when registering, enter the password, and click Login below to enter the account registration page to log in to the system.

Picture 2

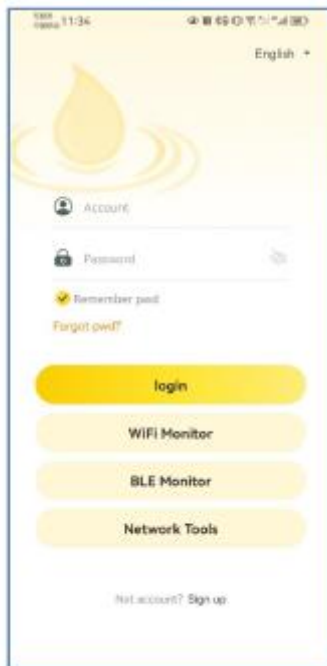

Retrieve the password

If you forget the login password of the App account, you can reset the account password through the process of retrieving the password.

- On the Login page, click Forgot Password,
- Enter the mobile phone number or email address you used when registering, click Get Verification Code,
- Enter the verification code page, enter the received verification code, and click OK,
- Reset the password, click OK,
- Click Login again after completion to log in with the new password.

Picture 3,4

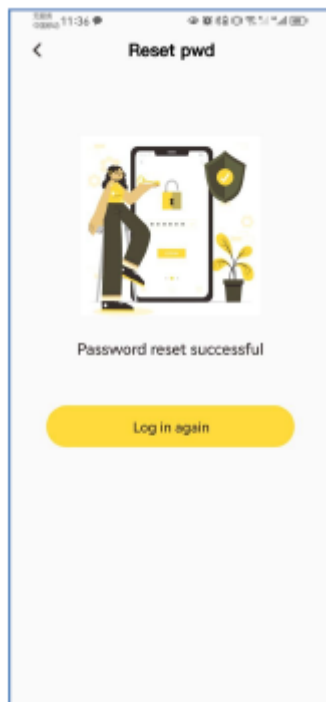
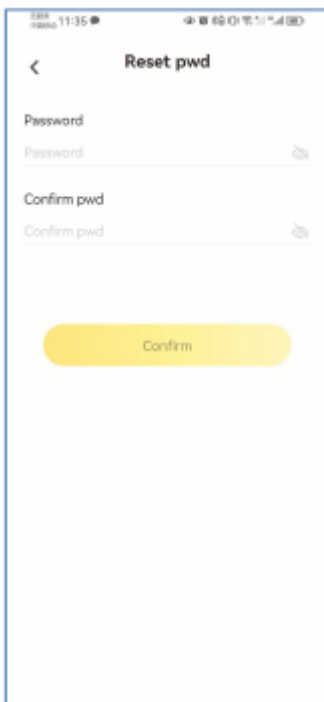

Registration

After entering the mobile phone number or email address, click Get Verification Code, enter the received verification code, set the password, and click Register Now to complete the registration.

Picture 5

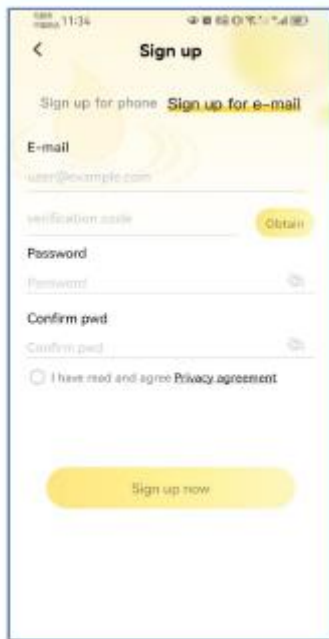

Multilingual

In the upper right corner of the login interface, set the language displayed by the entire APP. Currently, Chinese and English are supported.

Picture 6

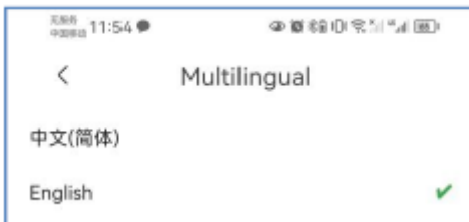

Device Information

Adding Device

On the Device Information page, click the + button in the upper right corner to enter the Add Device page. Add devices are divided into two ways: Bluetooth add and scan code add.

Picture 7



Bluetooth Add (only supports devices with Bluetooth module)

When using the Bluetooth add function, you need to allow the App to enable Bluetooth and positioning rights. If Bluetooth permission is not enabled, nearby Bluetooth devices cannot be searched. And some Android phones need to turn on the positioning system before they can be used.

1. After making sure that the device is powered on, click "Bluetooth Add", select the device with the same device name/PN, and click the icon;

Picture 8

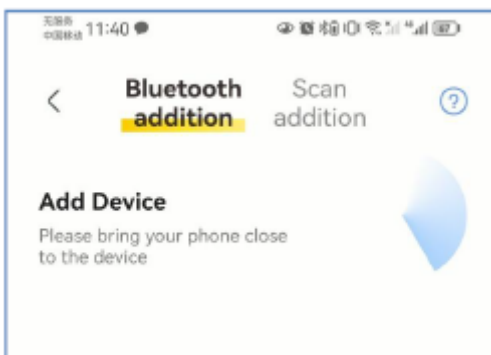

2. If it is a data acquisition device using GPRS or 4G module, the addition is successful if "" is displayed after the device.

3. If it is the data collector of the Wi-Fi module, it will continue to enter the networking interface to configure the network:

a. Select the router to be configured and fill in the password, and click the "Start Networking" button;

Picture 9,10



b. After entering the configuration, wait for 30s,APP will feedback information according to the distribution network result:

i. If the distribution network is successful, it means that the addition is successful. After waiting for about 5 to 10 minutes, the device data can be viewed normally;

ii. If the configuration fails, troubleshoot the problem according to the diagnosis results and repair suggestions.

Picture 11



Sweep Code Add

1. Click "Scan Code Add" to scan the QR code of the data collector, or click "Enter PN" in the lower left corner to complete the addition of equipment.

Picture 12



2. After the device is added, you also need to ensure that the device data can be uploaded to the cloud. If the data collector does not have a network, the data cannot be uploaded to the cloud.

- If you are using GPRS or 4G module, you need to ensure that the flow card can be used normally.

- If you are a data collector of the Wi-Fi module, you need to connect the data collector to the Wi-Fi network (for details, please refer to "2.2.6 Network Distribution Tool")

Picture 13



Device List

On the Device Information page, click ", you can view all devices under the account;

Picture 14



Device monitoring

It can support viewing the currently selected data collector PN, temperature, PV voltage, PV power, Daily power energy, Utility status , Operating mode and fault alarm.

Note: To view the fault alarm, you need to click View. After clicking, the "All Alarms" window will pop up.

Picture 15

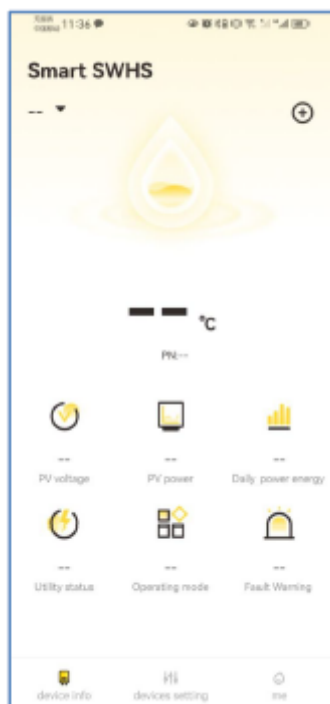

Device Settings

Device name

Display the device name of the currently selected device, and click "Icon jumps out of the" Edit Device Name "window, enter the device name, and click the" Agree "button;

Picture 16

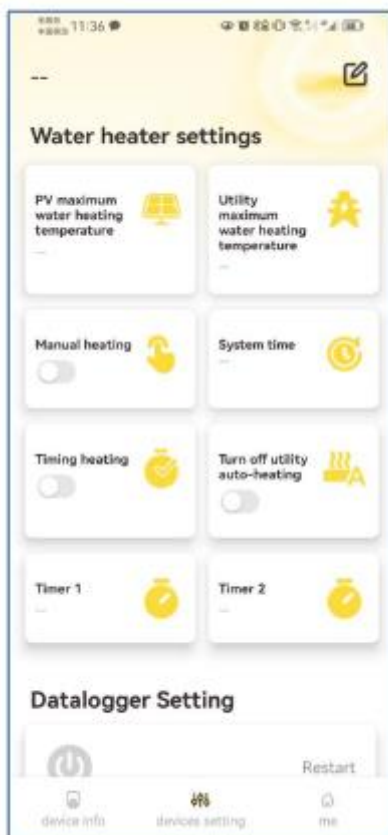

Water heater settings

- On the device information page, click the "Device Settings" button in the navigation bar at the bottom to enter the device control interface;
- Device Control: Read/control a control item

Picture 17



Data collector Setting

- On the Device Information page, slide down to the bottom;
- Click the "Restart" button to re-select the currently selected device;
- Click "Delete" button and "OK" to delete the currently selected device;

Pictur18

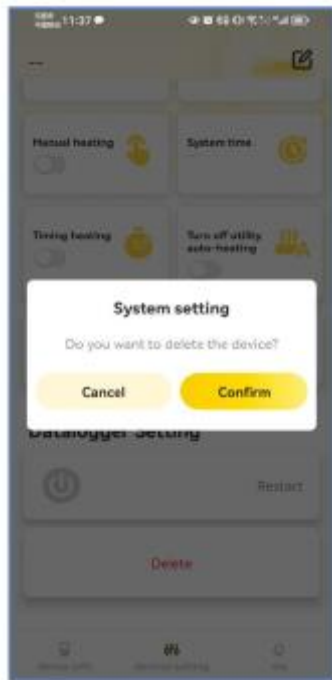

Me

Click the "Me" button in the bottom navigation bar to enter my interface,

Piture19

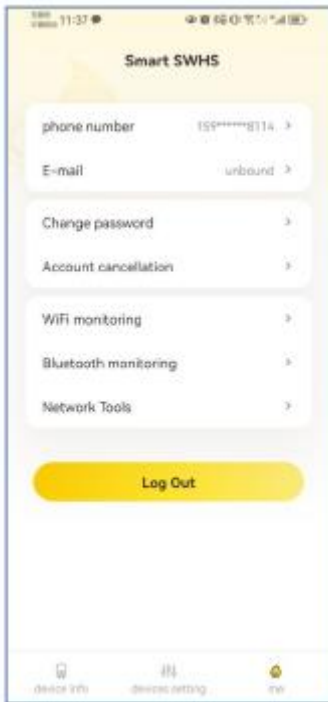

Mobile Phone Number/Email

● Click the mobile phone number, and click Mailbox if you need to change the mailbox. The following is an example of changing the phone number:

- Click Change phone number.
- Enter the mobile phone number to be replaced, click Get Verification Code, enter the received verification code, and click OK to replace it successfully.

Picture 20 , 21, 22

11:37

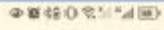

phone number



your mobile number 159**8114**

After changing the phone number, the new number will be used to retrieve the password.

Replace binding

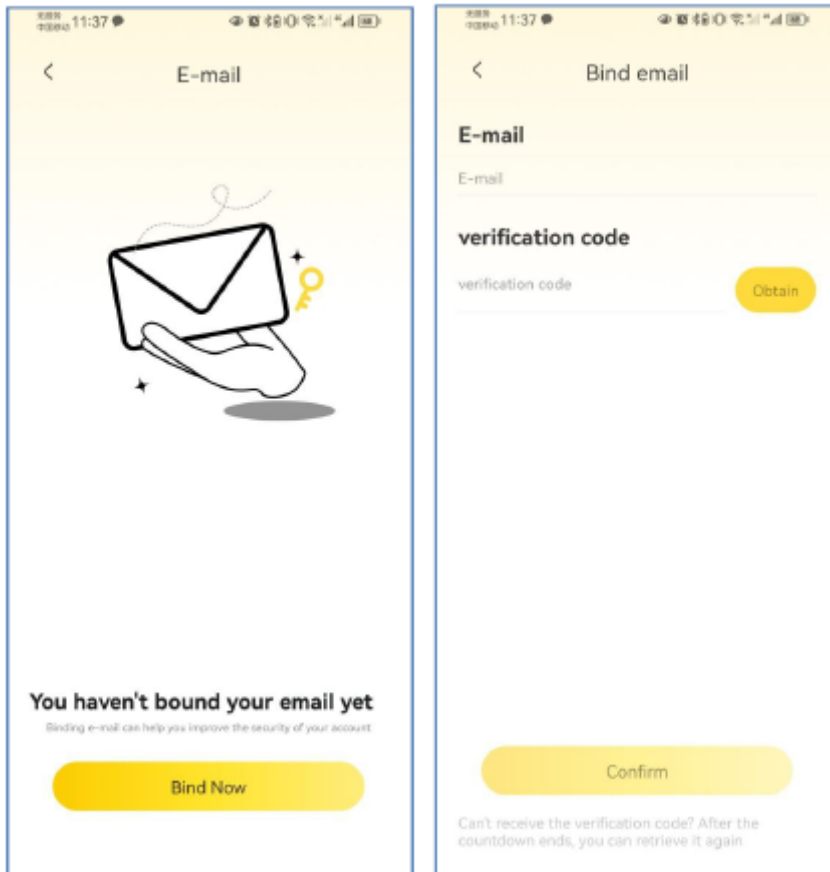

Change the password

- Click Change Password to enter the Change Password page,
- Enter the original password and the new password, and click OK to modify the password.

Picture 23

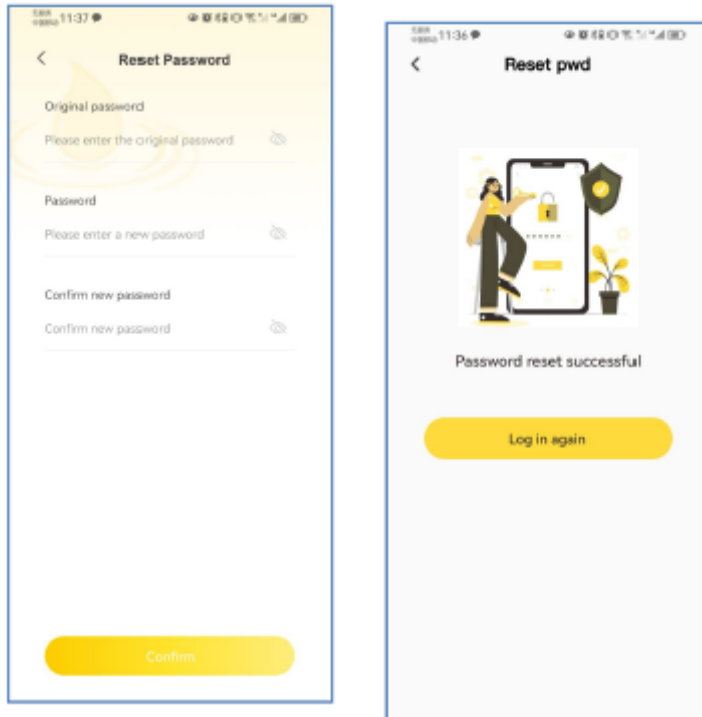

Account Cancellation

- Click Account Logout to enter the Account Logout page,
- Click the Confirm Logout button to enter the authentication page,
- Enter the original password and click OK (when there is no device under the account) to successfully apply.
- After waiting for 7 days, the account can be canceled, and the account can be registered again after the cancellation is completed.
- Support the cancellation application within 7 days of the application for cancellation, and support normal use after the cancellation is successful.

Picture 24

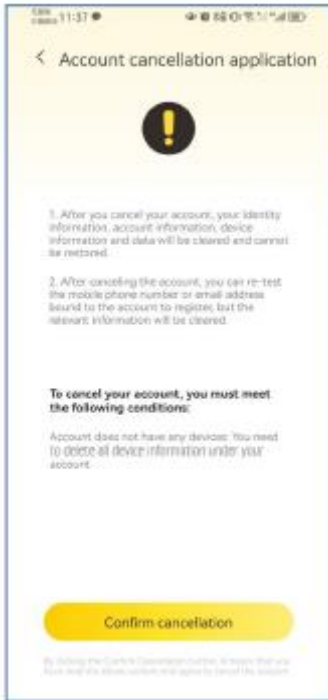

Wi-Fi Monitoring

- Enter my page, click Wi-Fi monitoring, enter the Wi-Fi connection interface;
- Click "System Settings" to open the WiFi list and select WiFi consistent with the data collector PN to connect;
- After connection, return to the Wi-Fi connection interface;
- On the device information interface, real-time parameter changes of the device per second can be monitored.
- In the device setting interface, a control item can be read/controlled.

Picture 25, 26, 27

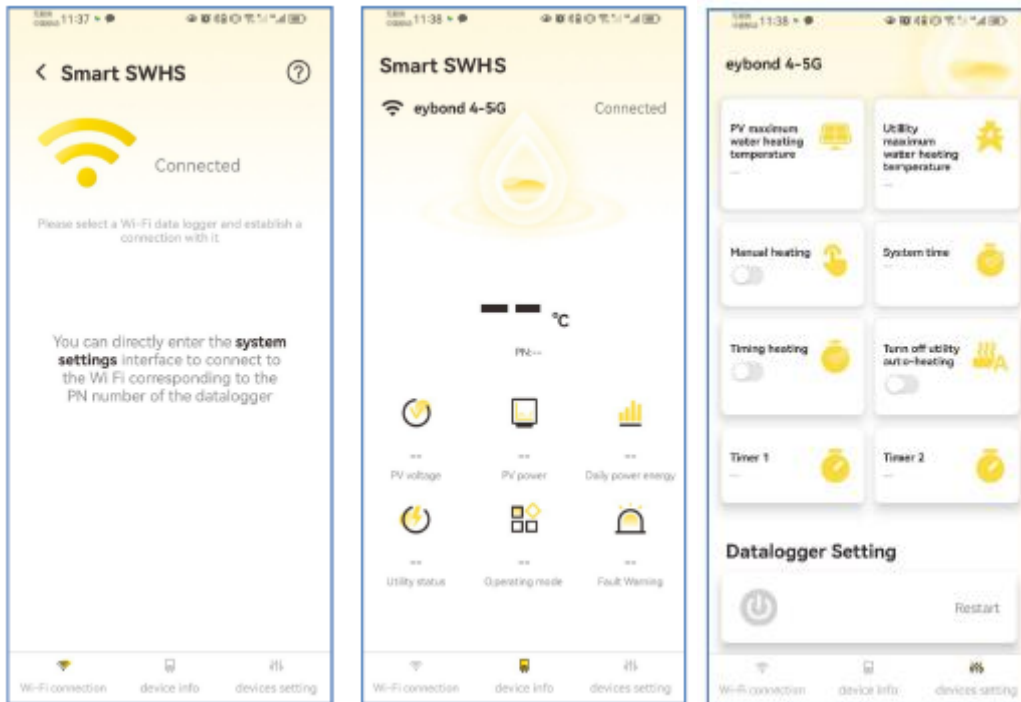

Bluetooth monitoring

- Enter my page, click Bluetooth monitoring, enter the connection device interface;
- APP scans nearby Bluetooth devices (make sure that the mobile phone turns on Bluetooth) and selects Bluetooth devices consistent with the data acquisition PN to connect;
- After the connection, it will enter the device information interface;
- On the device information interface, real-time parameter changes of the device per second can be monitored.
- In the device setting interface, a control item can be read/controlled.

Picture 28, 29, 30

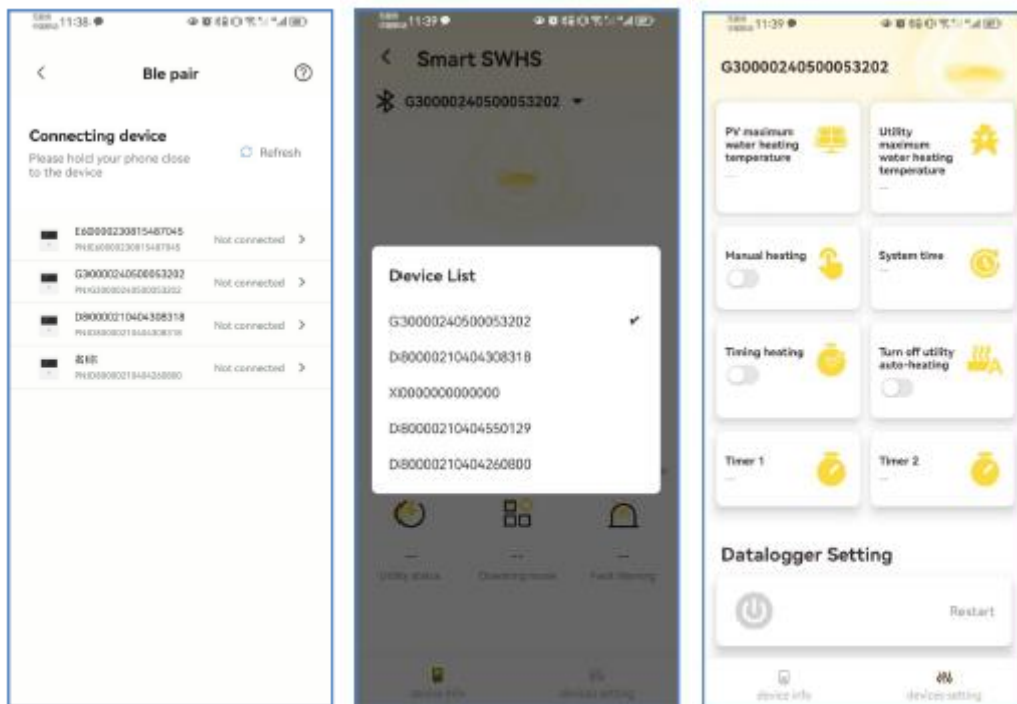

Distribution network tools

Entry 1: After adding the device through "Bluetooth Add", it will automatically enter the configuration network

Entry 2: Log in to APP and click "Networking Tools" on the "Me" page"

Picture 31, 32

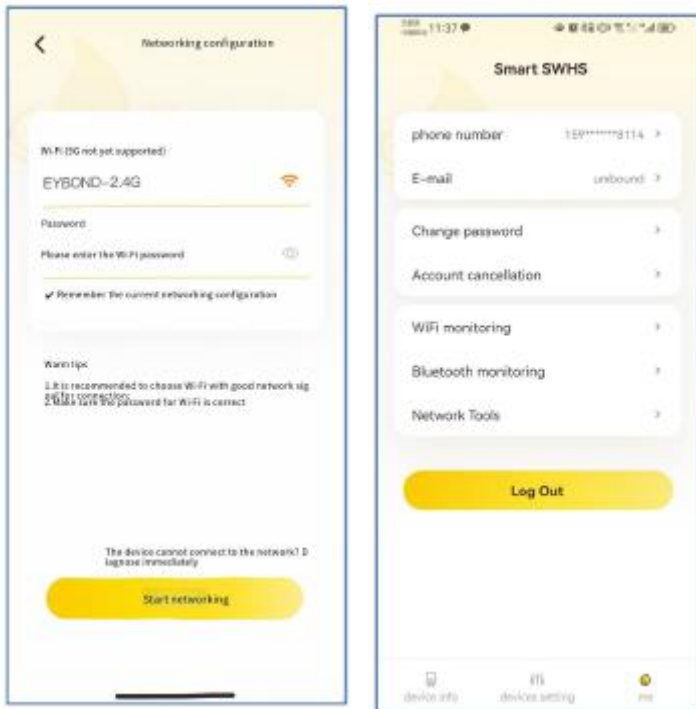

Distribution network process

Step 1: The mobile phone is connected to the data acquisition device.

APP scans nearby Bluetooth devices (make sure that the mobile phone turns on Bluetooth) and selects Bluetooth devices consistent with the data collector PN to connect.

Picture 33

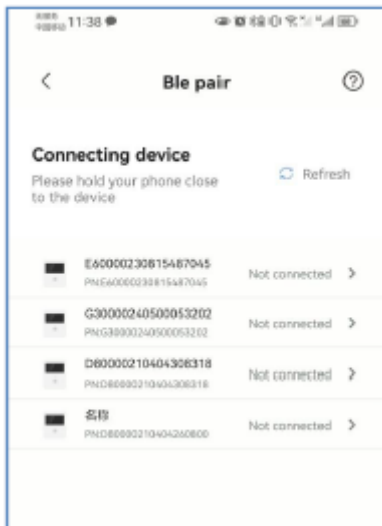

Step 2: Configure a network for the device

Click "Icon, select the router to be configured and fill in the password, and click the "Start Networking" button;

Picture 34

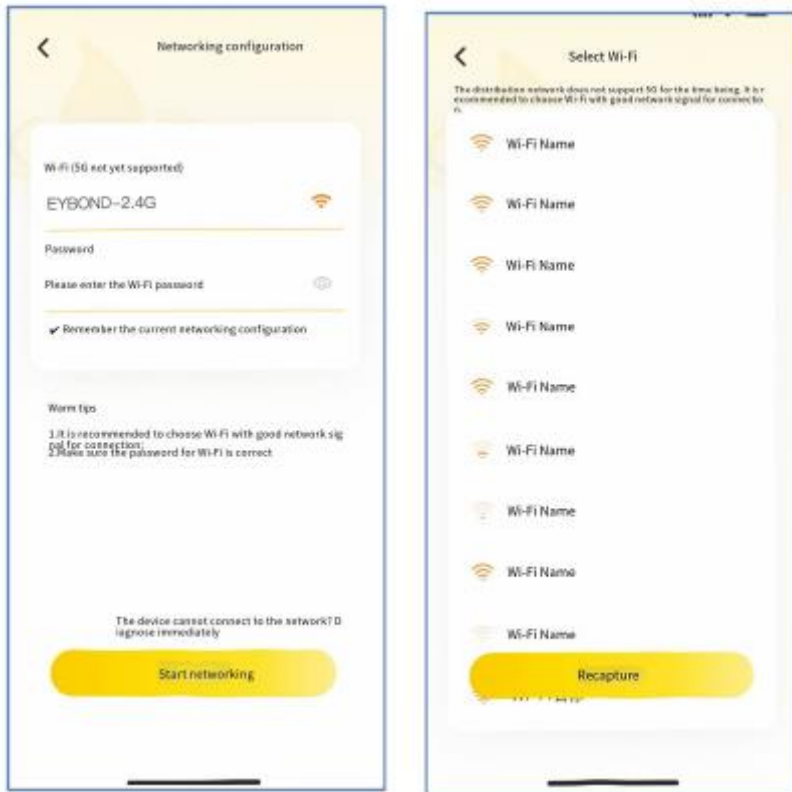

Note:

1. Please ensure that the signal connected to the network is good and the network is unblocked.
2. Currently, routers in 5G band are not supported, please use routers in 2.4G Band.
3. Make sure the router password is correct

Step 3: View Distribution Results

After entering the configuration, wait for 30s,APP will feedback information according to the distribution network result:

1. If the distribution network is successful, it means that the addition is successful. After waiting for about 5 to 10 minutes, the device data can be viewed normally;
2. If the configuration fails, troubleshoot the problem according to the diagnosis results and repair suggestions.

Picture 35, 36

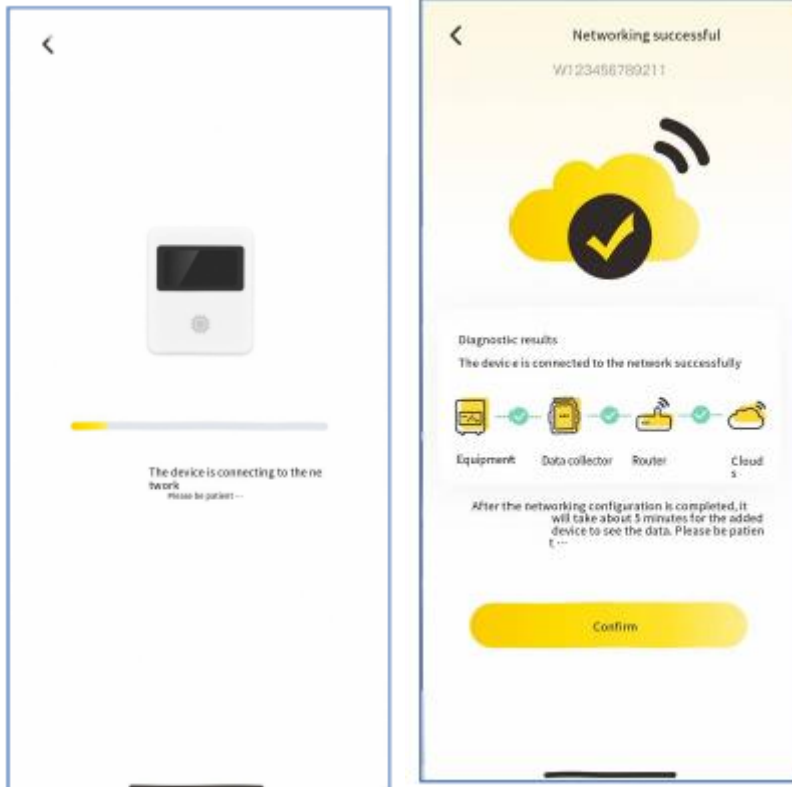

Logout

Click the "Logout" button to exit the current login account.

3. Wi-Fi Monitoring

Entry 1: APP login page, click the "Wi-Fi monitoring" button

Entry 2: Log in to APP and click "Wi-Fi Monitoring" on the "Me" page"

Picture 37, 38

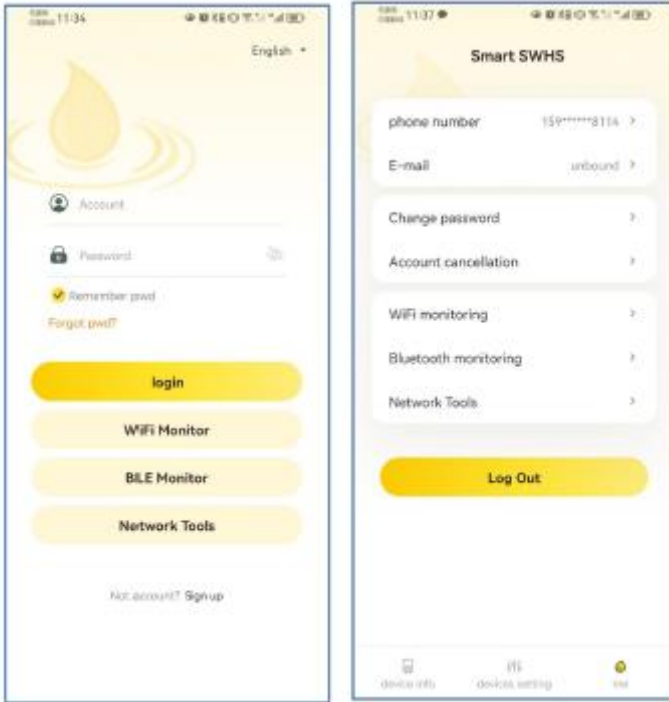

Wi-Fi connections

- Click "System Settings" to open the WiFi list and select WiFi consistent with the data collector PN to connect;
- After connection, return to the Wi-Fi connection interface;

Picture 39

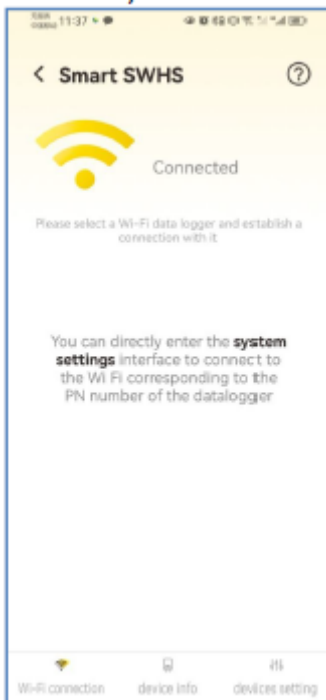

Device Information

After successfully connecting to the device WiFi, click the navigation "device information" at the bottom to enter the device information page.

Picture 40



Device Settings

- On the device information page, click the "Device Settings" button in the navigation bar at the bottom to enter the device control interface;
- Device Control: Read/control

Picture 41

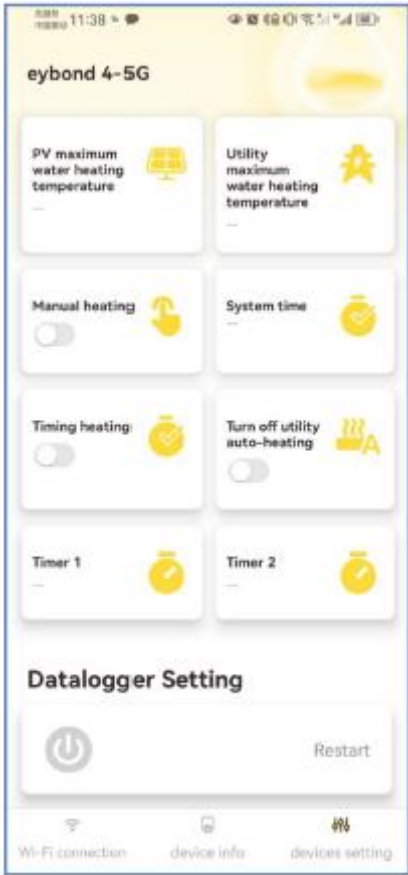

4. Bluetooth monitoring

Entry 1: APP login page, click the "Bluetooth Monitoring" button

Entry 2: Log in to APP and click "Bluetooth Monitoring" on the "Me" page"

Picture 43,44

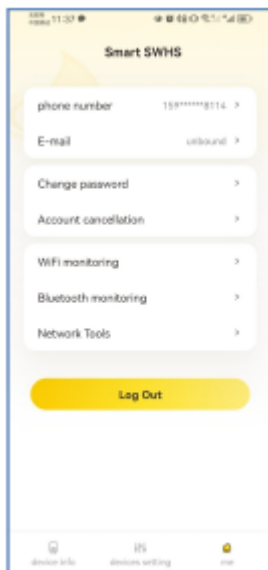
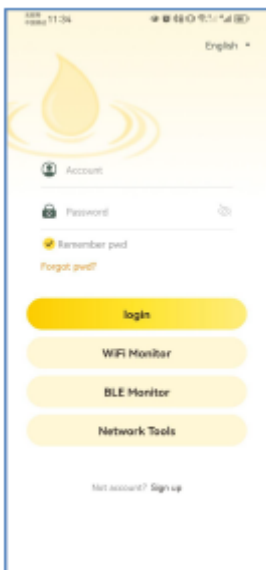

Device nearby

- Enter my page, click Bluetooth monitoring, enter the connection device interface;
- APP scans nearby Bluetooth devices (make sure that the mobile phone turns on Bluetooth) and selects Bluetooth devices consistent with the data collector PN to connect;
- After the connection, it will enter the device information interface;

Device Information

After successfully connecting to the device WiFi, click the navigation "device information" at the bottom to enter the device information page

- On the device information interface, real-time parameter changes of the device per second can be monitored.

Device Settings

On the device information page, click the "Device Settings" button in the navigation bar at the bottom to enter the device control interface;

- In the device setting interface, a control item can be read/controlled.

Picture 45

